

# Springfield School District

**SCHOOL SECURITY  
AND SAFETY NEEDS**



**Information on  
School Campus Security and Safety Needs**

# PHYSICAL PLANT NEEDS

This is how the committee bundled the needs.

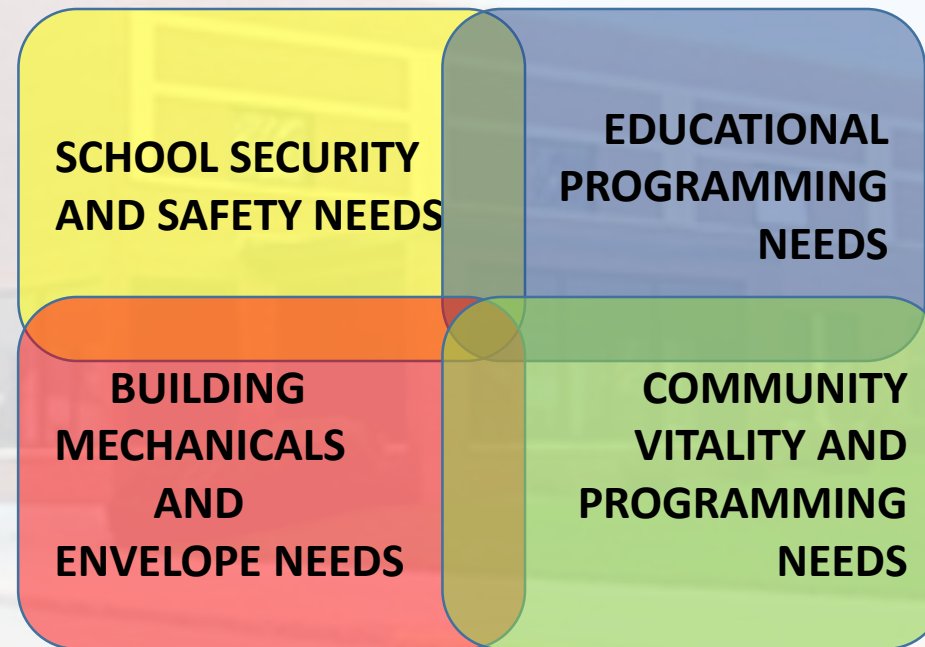

- 1) Brainstorm ideas that would be best to address if we were able to address them.
- 2) Report ideas to the group
- 3) Identify the Benefits. What is the deliverable benefit and who benefits?

**SCHOOL SECURITY  
AND SAFETY NEEDS**

Key Question? If the School District was able to address the school security and safety needs, what would you like to see that include? What would be the best means of addressing these needs? Relative to:

- \*Secure Entrances
- \*Main Entrances Functionality
- \*Space for kids to go afterschool who don't go home
- \*Parent Pick-up and Drop Off Areas
- \*Parking Lots

**SCHOOL SECURITY  
AND SAFETY NEEDS**

## School Safety Needs that were identified and studied

- \*Secure Entrances
- \*No Central Main Entrance
- \*Improve Accessibility by Adding a Visible Main Entrance
- \*Create space for kids to go afterschool who don't go home
- \*Parent Pick-up and Drop-Off Zones
- \*Parking Lots

The committee reviewed concepts that would provide a more secure and safe environment that meet today's standards for our children, staff, and the community that utilize our school daily.

The next few slides and pictures will help articulate some of these concerns and why they need to be addressed.

# An example of a Visible Main School Entrance

## SCHOOL SECURITY AND SAFETY NEEDS

Secure Entrances and a Main entrance that could serve our day/night school and community usage would greatly improve security and safety for our campus. Visibility and prominence brings clarity to where visitors are to enter and “check-in” and for after school events as seen in examples below.

Example of a Visible/Intuitive Main Entrance



Example of a Visible/Intuitive Main Entrance

The schools that are most secure have single access entrances that have double doors coming in. If anybody happens to come in to do harm during the school day, they will basically get trapped between the two entrances. Glass today can repel threats.



# Google It- Here is our school campus

## SCHOOL SECURITY AND SAFETY NEEDS

A more recent view would include the addition of the East Parking Lot by the Greenhouse.

There are advantages of having the school facility in the heart of a community. One issue is being landlocked and lack of available greenspace for students.



# Parking Lot Locations. Expanding East Lot has been beneficial.

## SCHOOL SECURITY AND SAFETY NEEDS

Here is designation of the parking lots around the school.

Expanding the east parking lot greatly improved the safety around the building.

Moving the students vehicles off the residential areas have made safer conditions for pedestrians and students biking to school.

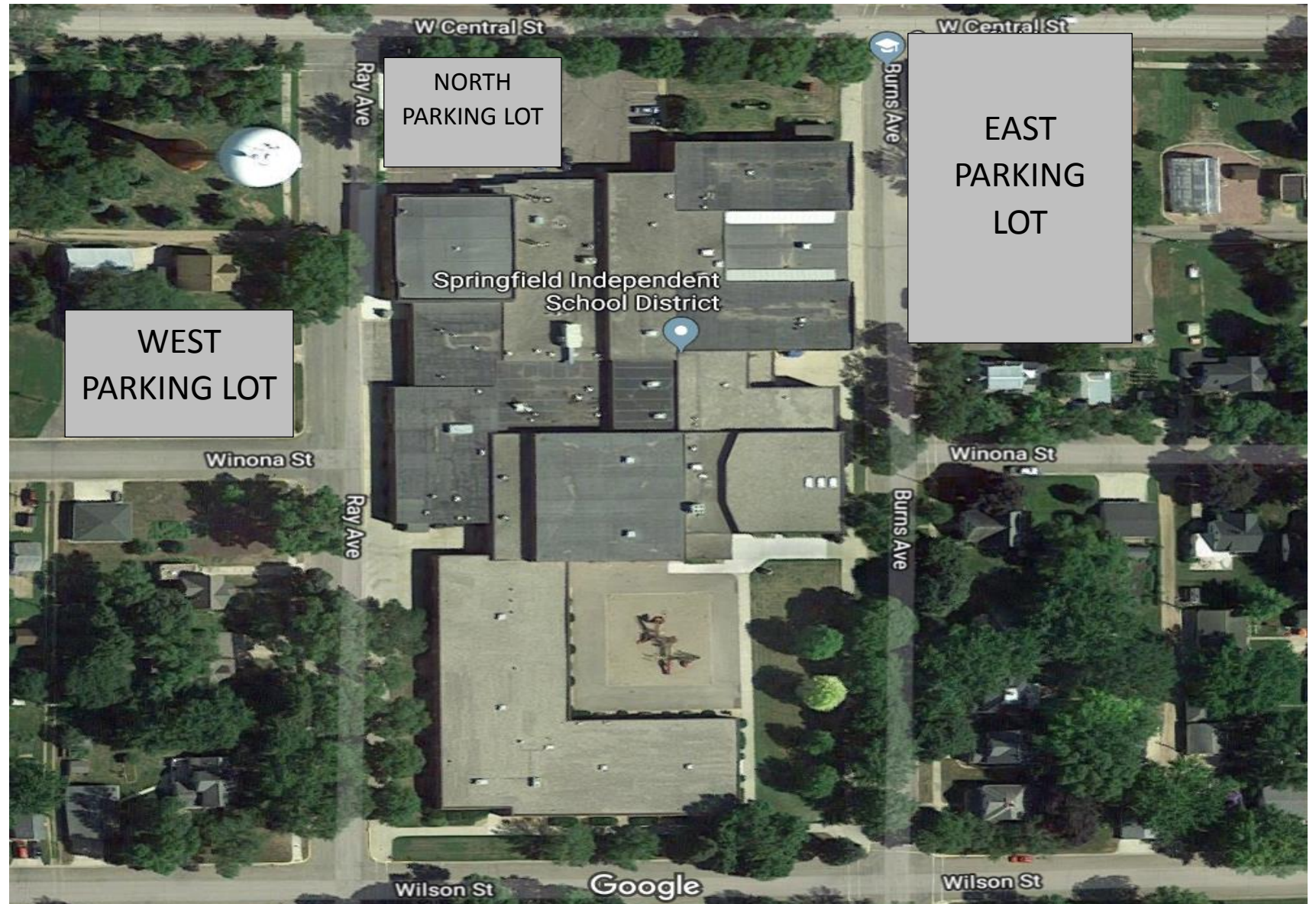

# Day Entrances

## SCHOOL SECURITY AND SAFETY NEEDS

Here are the designated entrances we want people to use during the school day.

There are issues with how they are designed as they don't meet the safety features sought after in today's school buildings.

Another issue is they are not intuitive. People consistently identify that they are not sure where to enter our school.

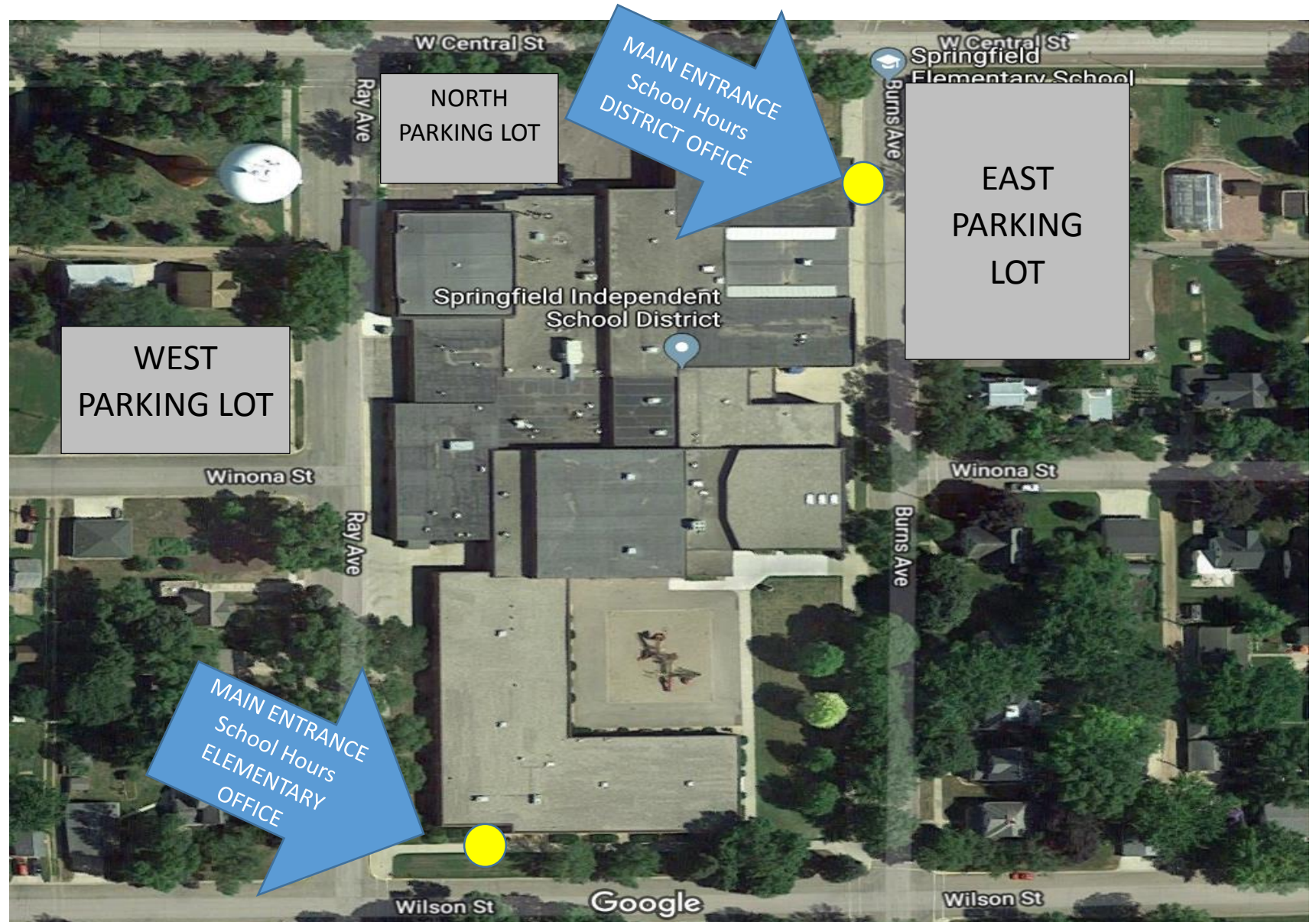



# A main school controlled entrance would benefit the students and visitors to our school.

## SCHOOL SECURITY AND SAFETY NEEDS

The High School Principal Offices are located on the 2<sup>nd</sup> Floor buried inside the building lacking accessibility to the public as it is not in a forward and prominent position.

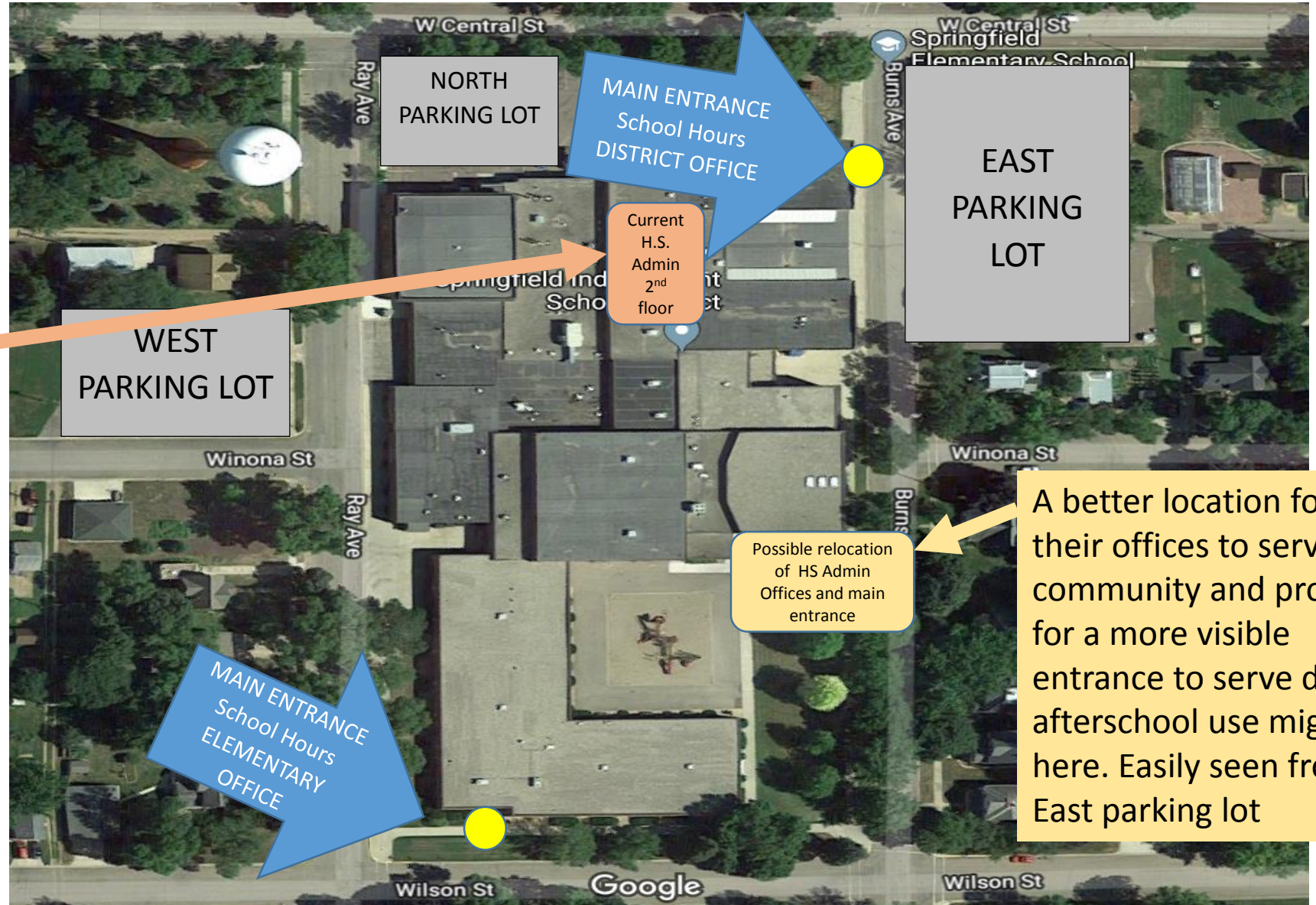

A better location for their offices to serve the community and provide for a more visible entrance to serve day & afterschool use might be here. Easily seen from East parking lot

# Currently our After School Entrances are not Intuitive and Different from Day Entrances.

## SCHOOL SECURITY AND SAFETY NEEDS

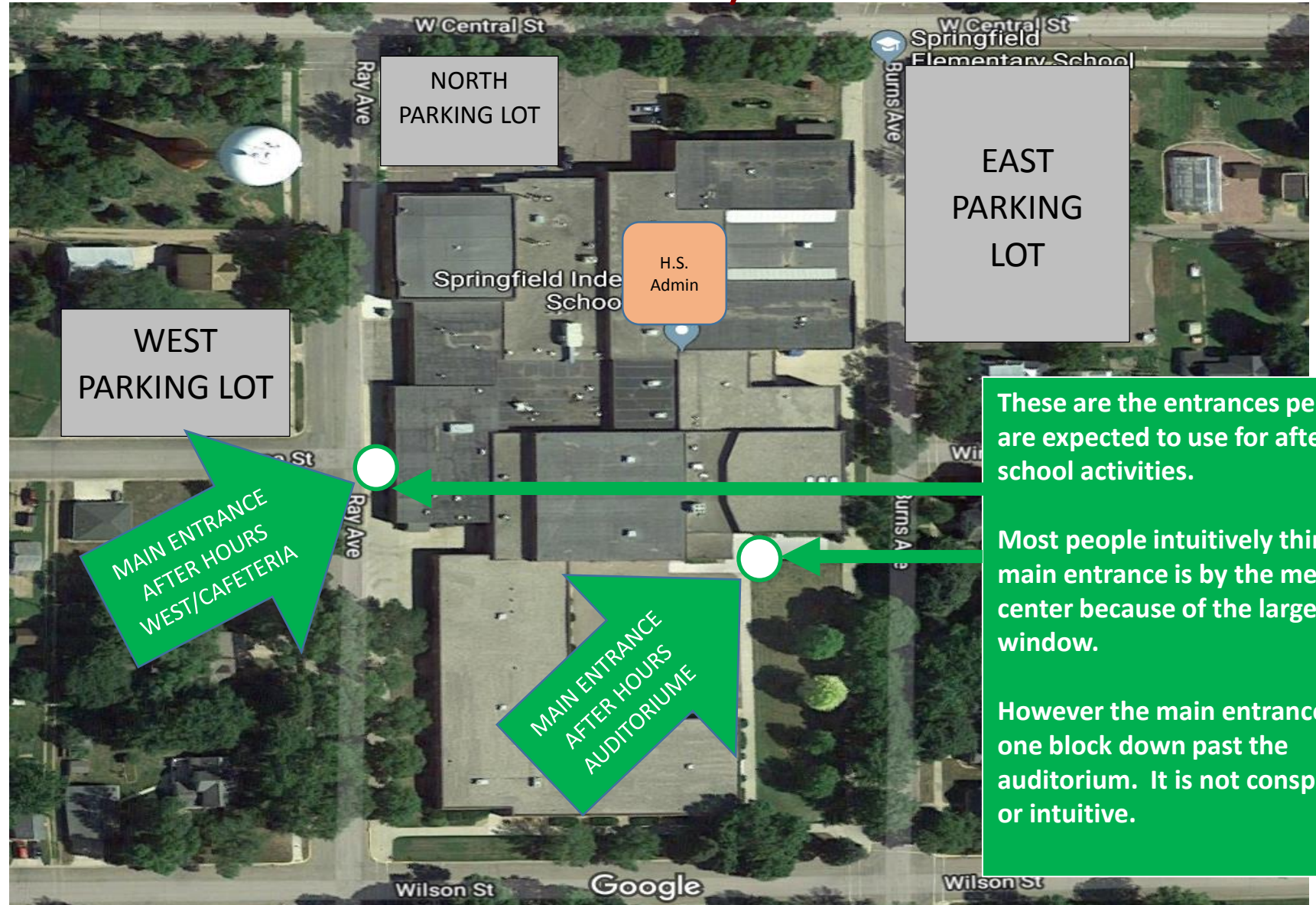

These are the entrances people are expected to use for after school activities.

Most people intuitively think the main entrance is by the media center because of the large bow window.

However the main entrance is one block down past the auditorium. It is not conspicuous or intuitive.

# School Building Lacks an intuitive main entrance that can better regulate access

## SCHOOL SECURITY AND SAFETY NEEDS

The district monitors two entrances for afterschool activities and two different entrances for daytime school use. It would be most functional and provide a “safer school environment” if one main entrance existed that could be utilized for both day and night.

Below is the East side of the school which coexists with our main East parking lot. The District Office Entrance is for day use and the auditorium entrance is one of the two entrances for night use.

Opportunities exist to create a main entrance that would provide necessary safety measures, be very functional, and intuitively clear that this is where school visitors should enter.

Visitors to our school, especially after school hours, really don't have a clear understanding where to go.

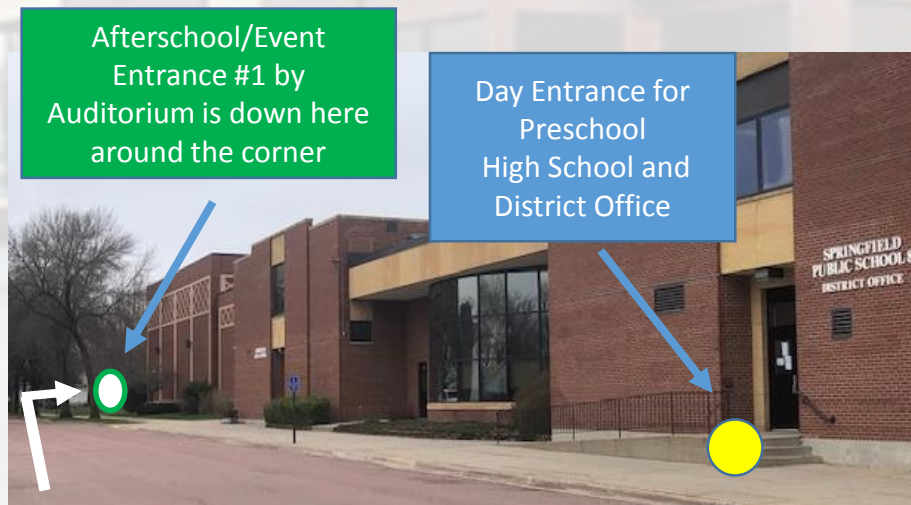

View from East Parking Lot  
Afterschool entrance(O) is not visible or intuitive

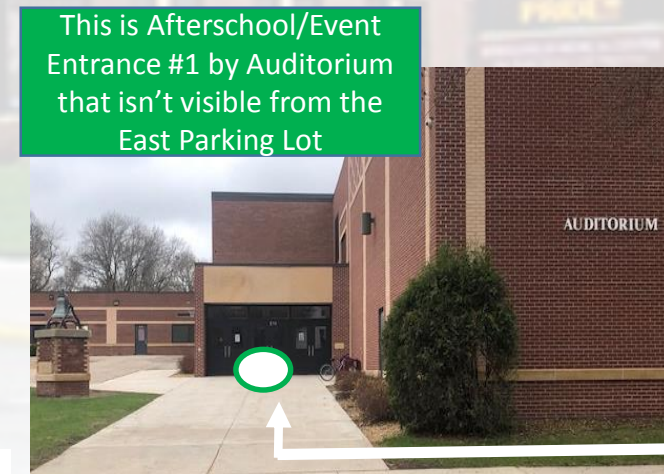

View from Burns Ave. south of Winona

## SCHOOL SECURITY AND SAFETY NEEDS

This is our second entrance on the West side of the building used for after school events.

This is Night Entrance #2 by the cafeteria.  
This is a picture from the West parking lot.

The West parking lot is a smaller lot that can hold about 28 vehicles.

This entrance lacks function and requires another door to monitor for community events.

Having the West Parking and this entrance for staff use may function the best.



# An Example of a Controlled School Entrance

## SCHOOL SECURITY AND SAFETY NEEDS

Key issue: Today's safety standards for schools include a Main Entrance housing an administrative office with a controlled entrance that requires you enter through it prior to accessing the building. The schools that are most secure have single access entrances that have double doors coming in. If anybody happens to come in to do harm during the school day, they will basically get trapped between the two entrances. Glass today can repel high level threats.

Another concern is that the high school principal office is buried on the second floor and not accessible to the public. About 8 out of 10 visitors that come through the district office need to access high school office & staff.

Example



Controlled entrance example

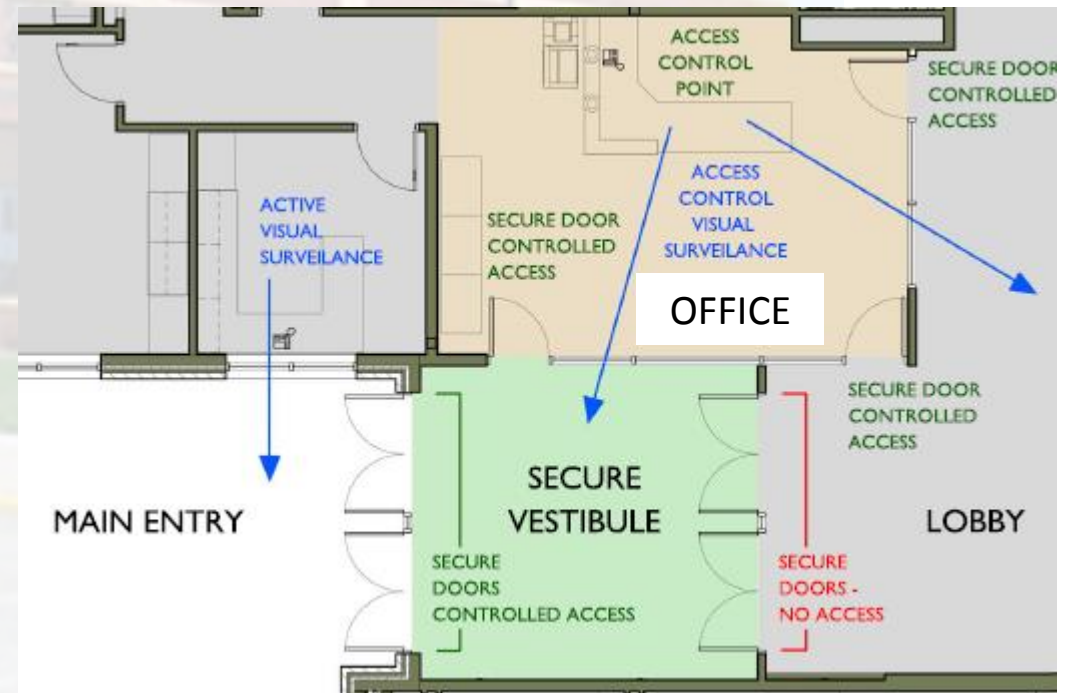

# Our current entrance E1 serves as the main school day entrance for the Preschool, High School and District Office. It needs a controlled entrance

## SCHOOL SECURITY AND SAFETY NEEDS

Lack of Controlled Entrances/Vestibules.

A concern is that our existing entrances are not controlled.

We buzz people in, but visitors are not forced to enter through an controlled entrance.



This is the main school-day entrance E1 for the high school and district office. It was built in 1951. It is located by the preschool, early childhood classrooms, and district office.

The district installed a “buzz-in” system in 2013 to help control building access. A concern exists where visitors after being “buzzed-in” are not regulated to enter into an administrative office.

8 out of 10 visitors that enter here need to go to the High School Office located on the 2<sup>nd</sup> floor. Many elementary visitors come through here too, but need to be redirected to the other corner of the building.

A common complaint is that people never know which door they should use to enter our school.



This is the same entrance E1 by the preschool. After visitors are “buzzed” in, they can access the upstairs as the construction design in 1951 when this part of the school was built did not have the safety features sought after in today’s school buildings.

Our current entrance S1 serves as the other main school day entrance for the Elementary Office. It also needs a controlled entrance.

**SCHOOL SECURITY AND SAFETY NEEDS**

Lack of Controlled Entrances/Vestibules.  
A concern is that our existing entrances are not controlled.  
We buzz people in, but visitors are not forced to enter through a controlled entrance.



This is the entrance S1 by the elementary principal office. After visitors are “buzzed” in, they can access the elementary without. This construction design is from 1994 and is one of the most recent section of our school. At that time, school’s were not built with the safety features sought after in today’s school buildings.

# Parent Pick-Up and Drop Off Zones

## SCHOOL SECURITY AND SAFETY NEEDS

A concern is that the parent drop zone off of “Burns Avenue” is problematic. Snow can't be cleared along the grass boulevard. Kids are dropped off and climb over the snow while exiting their vehicles. At times the snow bank can get slippery causing more concerns with kids slipping under a vehicle.



Main Elementary Parent  
Pick-up and Drop-Off Zone  
on Burns Ave.



# Parent Pick-Up and Drop Off Zones

## SCHOOL SECURITY AND SAFETY NEEDS

Along the south side of the elementary on “Wilson Street”, snow can’t be cleared along the grass boulevard. Here is an example of how families in this drop off/pick up zone climb over the snow to go to and from the school.



Parent Pick-up and  
Drop-Off Zone along  
Wilson Street.

# Facility Task Force Recommendation to address School Campus Safety and Security Issues.

## SCHOOL SECURITY AND SAFETY NEEDS

\*Consensus of this committee is to address the campus security and safety needs by the following:

- a) Create a Main Entrance by the auditorium with today's safety standards. Relocate the high school principal office in the most prominent area as seen in today's building designs to help improve school security, accessibility to the public, and can intuitively serve as the school's main entrance for day and night use.
- b) Remodel the Elementary and District Office Entrances to today's school safety standards of being a controlled entrance.
- c) Address parent pick-up and drop off zones and the high school office addition by the auditorium by acquiring property on Burns Ave. between Winona St. and Wilson St. This will improve the space issue of the school and allow a design of an improved parent pick up and drop off zones.
- d) Plan for a "safe" area for high school students to go after-school who don't go home as many wait for late practices, school programs, or for parent pick-up.

# School Site Plan Addressing School Safety and Security Needs.

## SCHOOL SECURITY AND SAFETY NEEDS

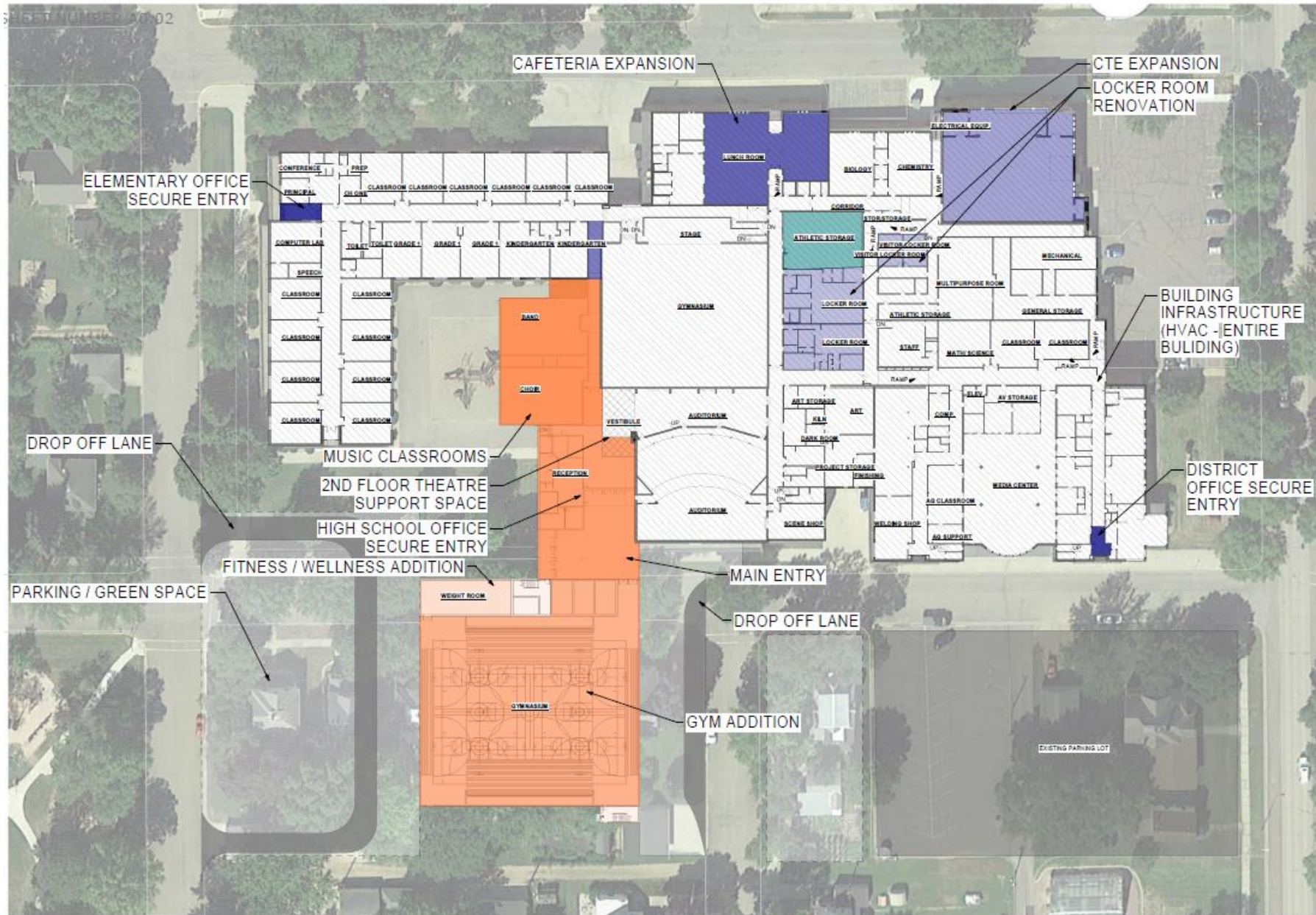

COSTS	
	BUILDING INFRASTRUCTURE (HVAC) 160,000 SF @ \$42 / SF = \$6,720,000
	SAFETY & SECURITY 523 SF @ \$173 / SF = \$90,479
	LAND + STREET = \$1,330,413
	H.S. OFFICES / MAIN ENTRY 6,562 SF @ \$350 / SF = \$2,296,700
	CTE EXPANSION 6,590 SF @ \$173 / SF = \$1,140,070
	LOCKER ROOM RENOVATION 4,287 SF @ \$173 / SF = \$741,651
	FITNESS / WELLNESS ADDITION 1,541 SF @ \$350 / SF = \$539,350
	GYM ADDITION 20,285 SF @ \$350 / SF = \$7,099,750
	CAFETERIA EXPANSION 4,147 SF @ \$173 / SF = \$717,431
	MUSIC CLASSROOMS 6,209 SF @ \$350 / SF = \$2,173,150 385 SF @ \$173 / SF = \$66,605
	2ND FLOOR WALKING TRACK 3,793 SF @ \$350 / SF = \$1,327,550
	2ND FLOOR THEATRE SUPPORT SPACE 1,000 SF @ \$350 / SF = \$350,000
	<b>TOTAL = \$24,593,149</b>

# Springfield School District



If you have any questions, please don't hesitate to contact:

Keith Kottke

Superintendent

507-723-4283

[keith.kottke@springfield.mntm.org](mailto:keith.kottke@springfield.mntm.org)